

A

Eaves Beam

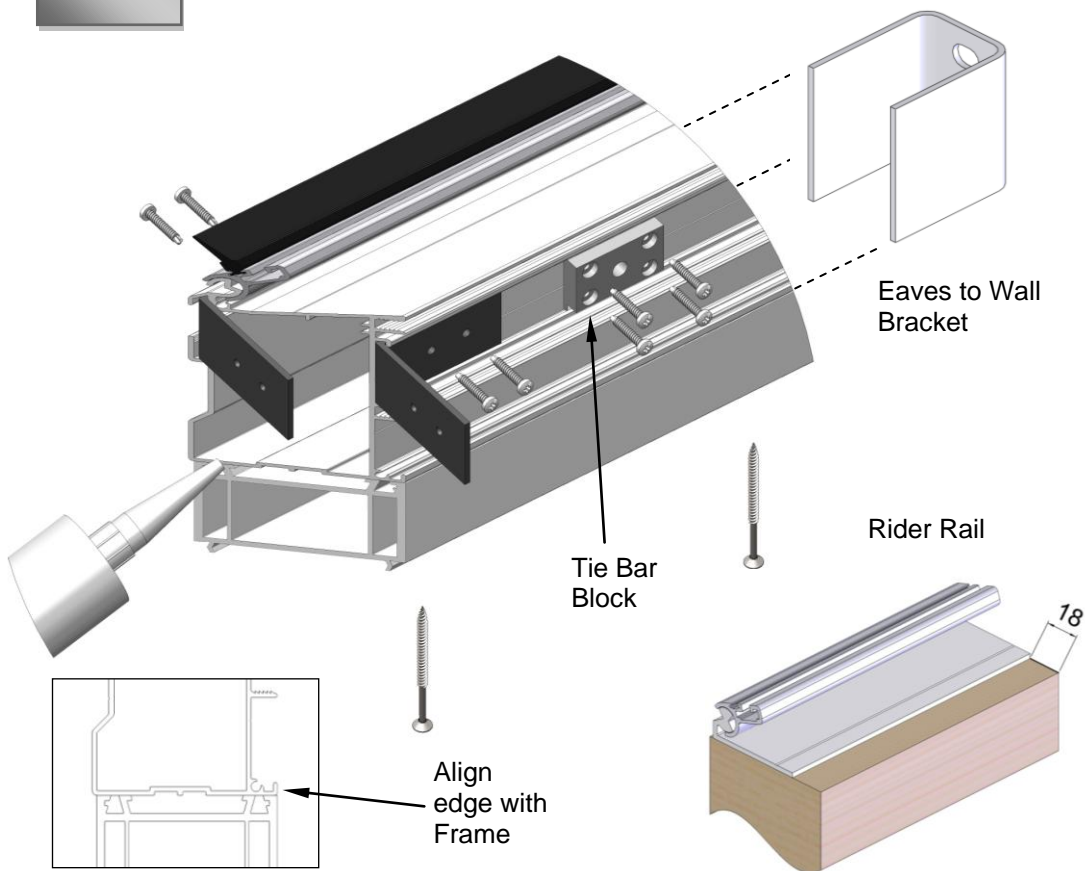

1. Starting at Wall, align Eaves Beam with inner face of Window Frame.
2. Fit Eaves Beam to Wall Bracket (if specified). Fitting detail in pack.
3. Clamp & screw Eaves Beam to frames from underneath at 500mm centres.
4. Insert Tie Bar Block (if specified).
5. Fit corner Cleats with screws provided.
6. Apply sealant to end profile
7. Apply sealant to external joint between Eaves Beam and window frames.
8. For Rider Rail, position 18mm from inner edge and screw in position from above.

B

Ridge

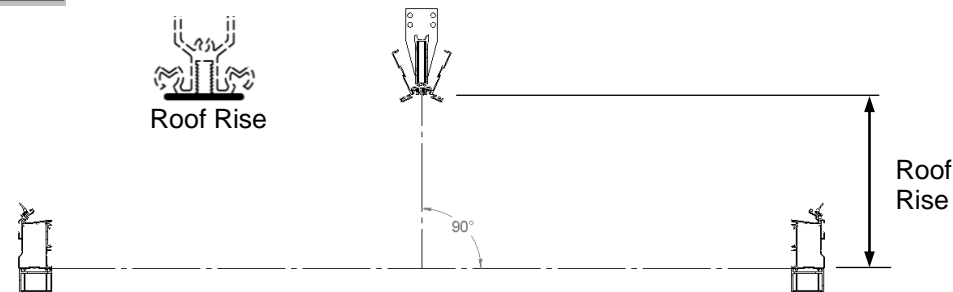

1. Accurately mark Roof Rise (from Roof Documents in component box) and Roof Centre on wall.
2. Align Base of Ridge Body with mark.
3. Mark drilling position of wall mounting bracket.
4. Remove central Ridge Cladding.
5. Prop Ridge Assembly near Gallery end. (Allow space for Undercap).
6. Drill & fix mounting bracket to wall. (Use 2x M10x100mm Rawl bolts).
7. Adjust Prop to ensure the Gallery end of the Ridge is 5mm above the Wall end of the ridge. (This allows for the Roof to settle back to level when the prop is removed.)
8. Fit & fix Wall Bars.

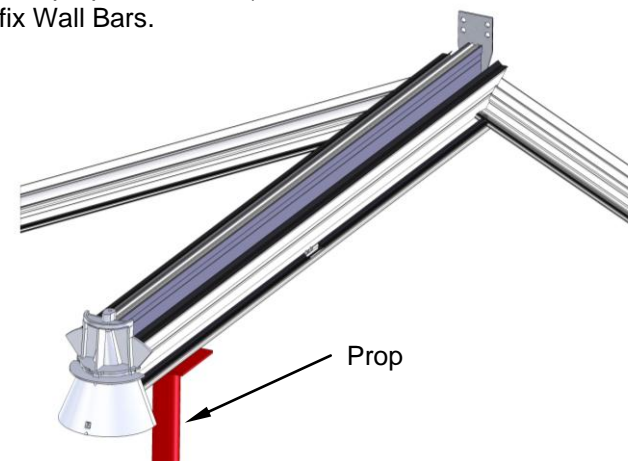



Glazing Bar at Ridge

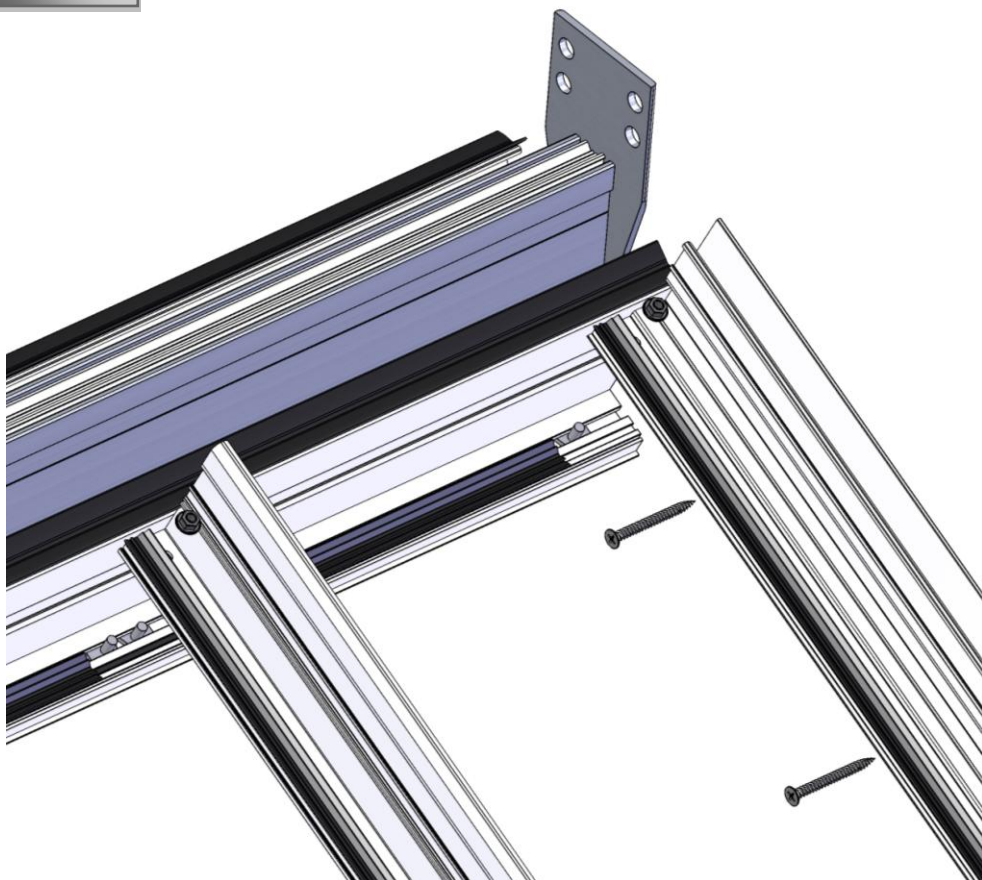

NOTE: Fit End Caps to Glazing Bars first if ends are inaccessible. (See Section E for details.)

1. Centralise silver Twinfast fixing between Gasket notch. (Use ½ Twinfast fixing for Wall bar.)
2. Locate Glazing Bar over Twinfast fixings.
3. Fix with 2x nuts provided.
4. Secure Wall Bar to wall at 600mm centres.



Glazing Bar at Eaves

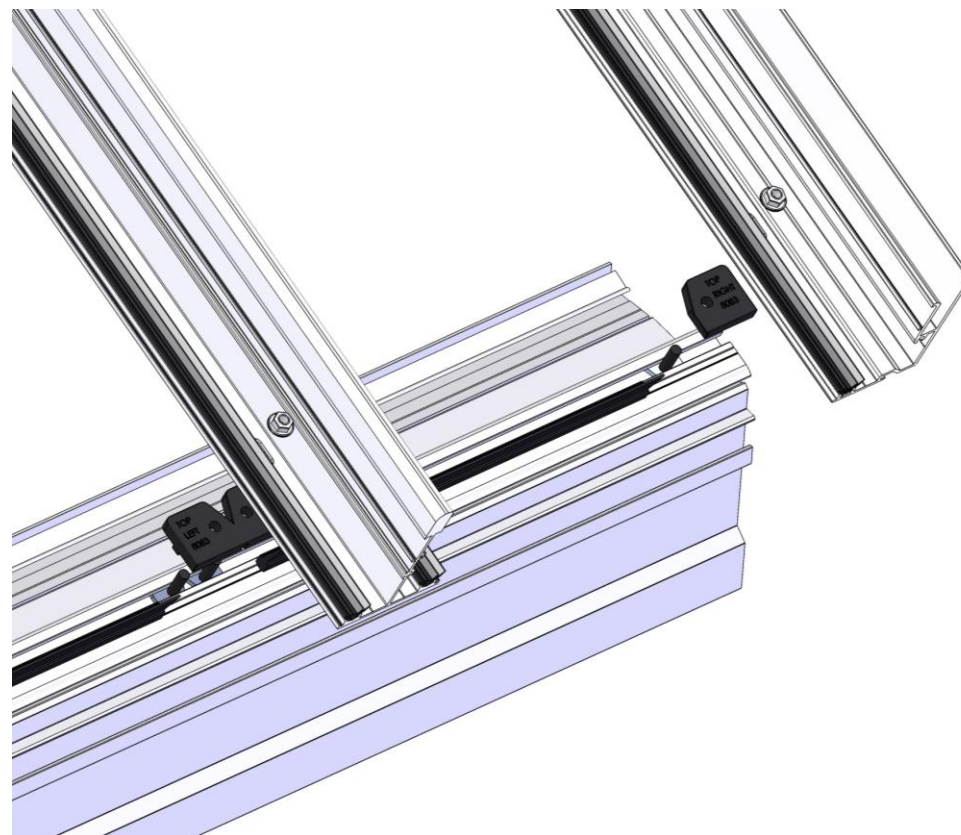

1. Put black plastic Spacer Block over black Twinfast fixing. (Use ½ Spacer for wall bar.)
2. Align Twinfast studs in middle of glazing bar slots.
3. Fix with 2x nuts provided.



Glazing Bars at Gallery

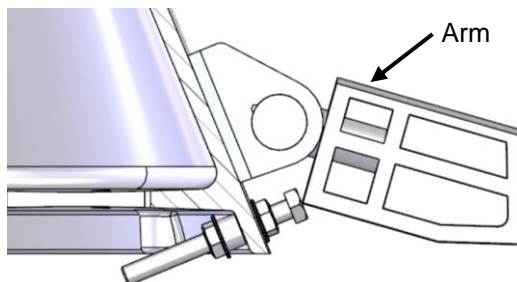
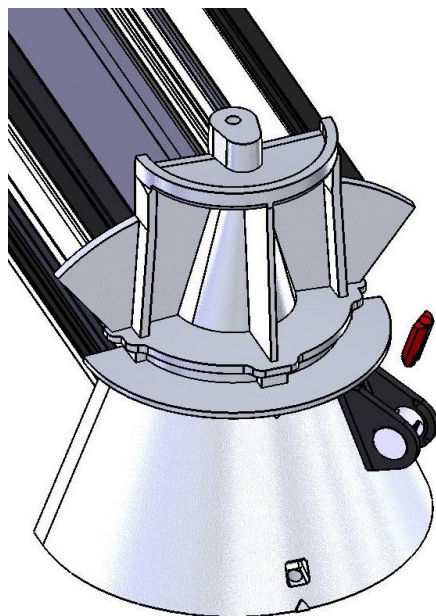

Jacking Screw Assembly
on Gazebo or Short Ridge Hip
Back roofs



1. NOTE: Fit End Caps first if Hip end is inaccessible. (See Page 8).
2. Remove red Clip then insert Bar into Silver Barrel at 45° and push fully home.
3. Bar should easily rotate back to the upright position. **DO NOT FORCE IT.**
4. Push red Clip in behind bracket Barrel to lock bar into place.

NOTE: Gazebo or short Ridge Roofs require Jacking Screws.
Ensure the Gallery/Ridge is perfectly upright. Adjust Jacking Screw so the bolt head just touches the Arm, then secure in place with nuts.



Hip Bar at Eaves

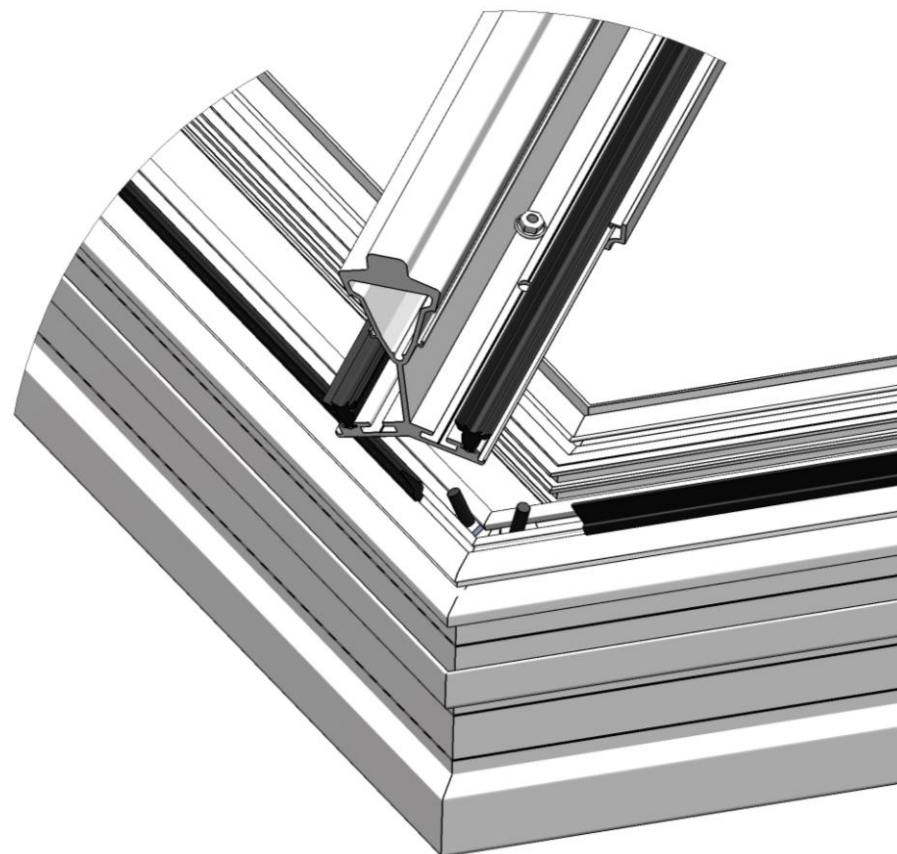

1. Ensure Twinfast fixings are in place.
2. Locate Hip Bar holes over Twinfast fixings
3. Secure Bar with 2x nuts provided.



Jack Rafter at Hip

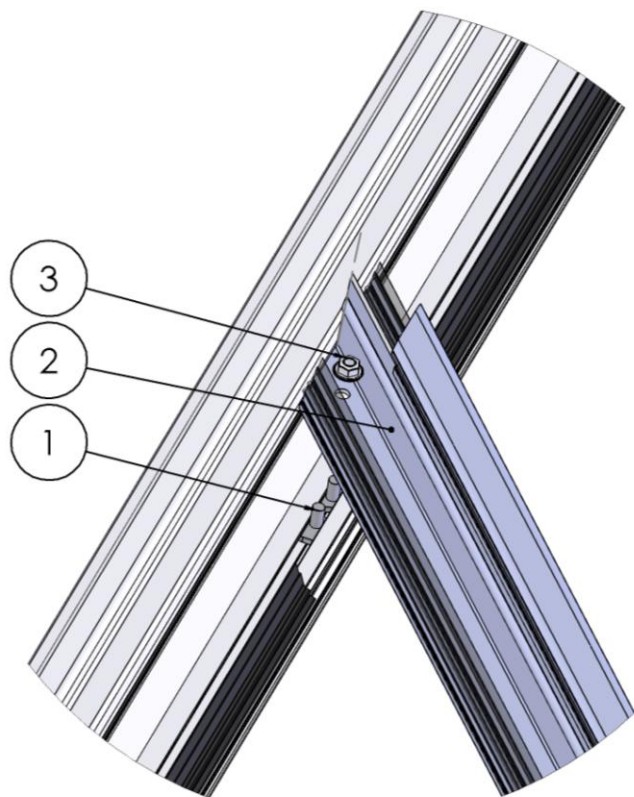

1. Space Twinfast fixing correctly.
2. Locate Jack Rafter over Twinfast fixings.
3. Secure Jack Rafter to Hip before fixing to Eaves Beam.
4. Fix with 2x nuts provided.



Jack Rafter at Eaves

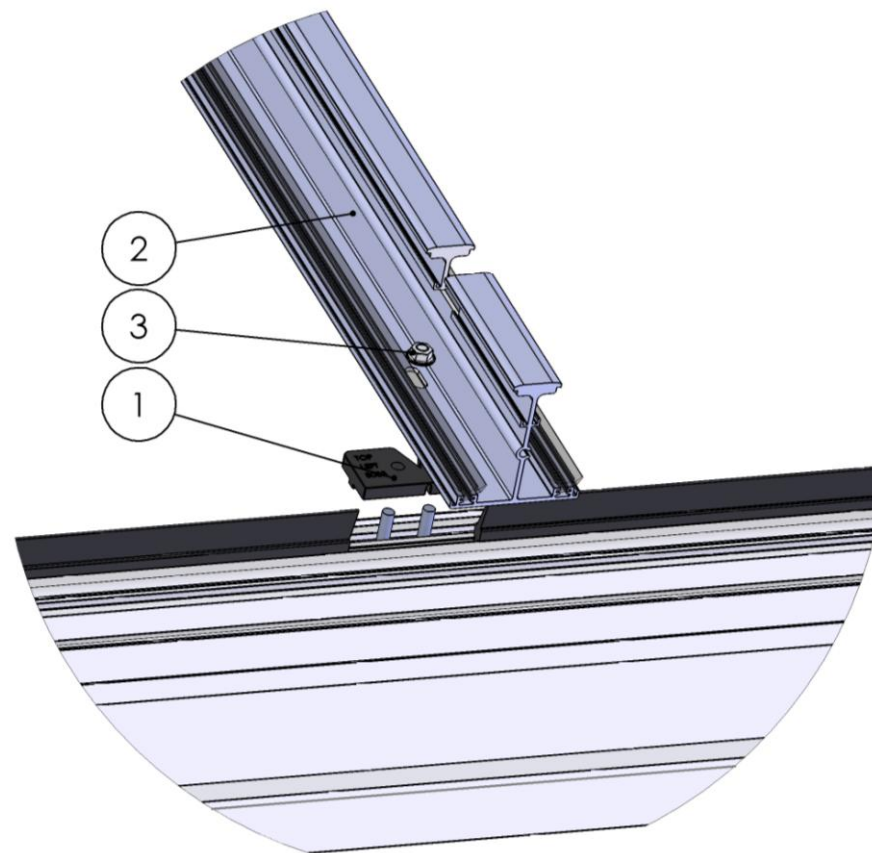

1. Put black plastic Spacer Block over black Twinfast fixing.
2. Align Twinfast studs in middle of Jack Rafter slots.
3. Fix with 2x nuts provided.

B

Ridge Cover

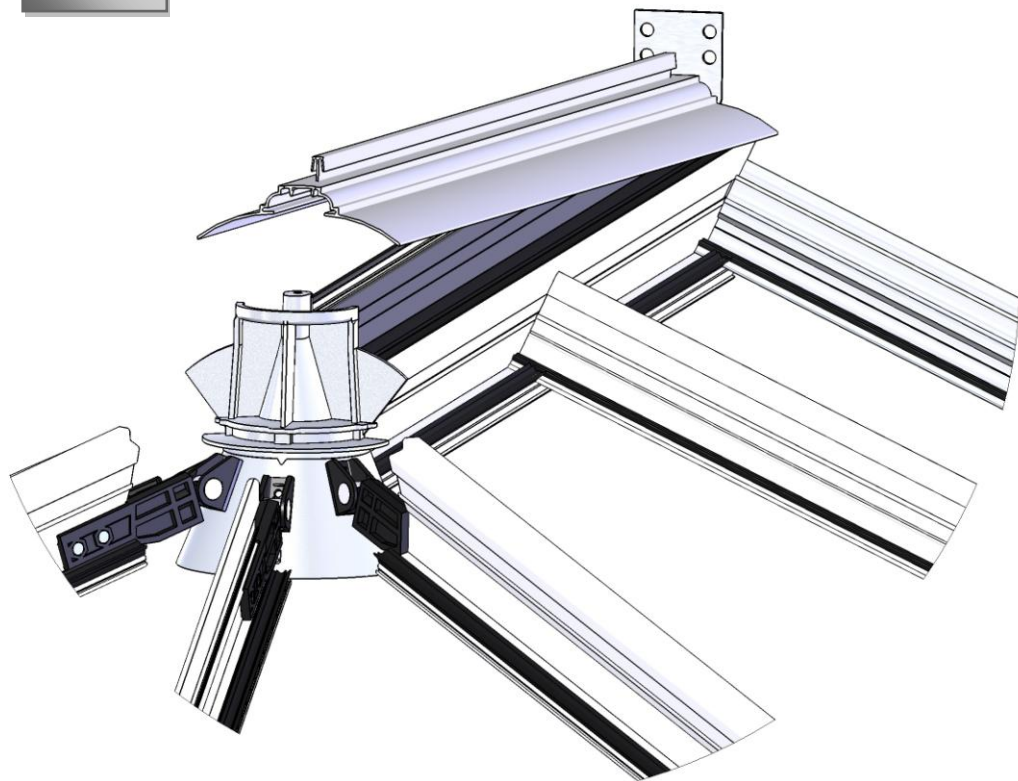

1. Starting at the wall end, tap Cover to engage with the Ridge Body using a large rubber mallet.
2. Ensure first 500mm is properly engaged before continuing along the profile.
3. Tap Ridge Cover every 100mm along profile. If Ridge cover feels “springy” when tapping, the cover has not engaged properly. Return to where the Cover feels solid and continue.

NOTE: The Ridge cover cannot be removed without damage once fitted. See Page 8 for Cross Section of Ridge for reference.

NOTE: See Page 6 for sealing inline Wing and Ridge Cover joints.

F

Flashing Trim

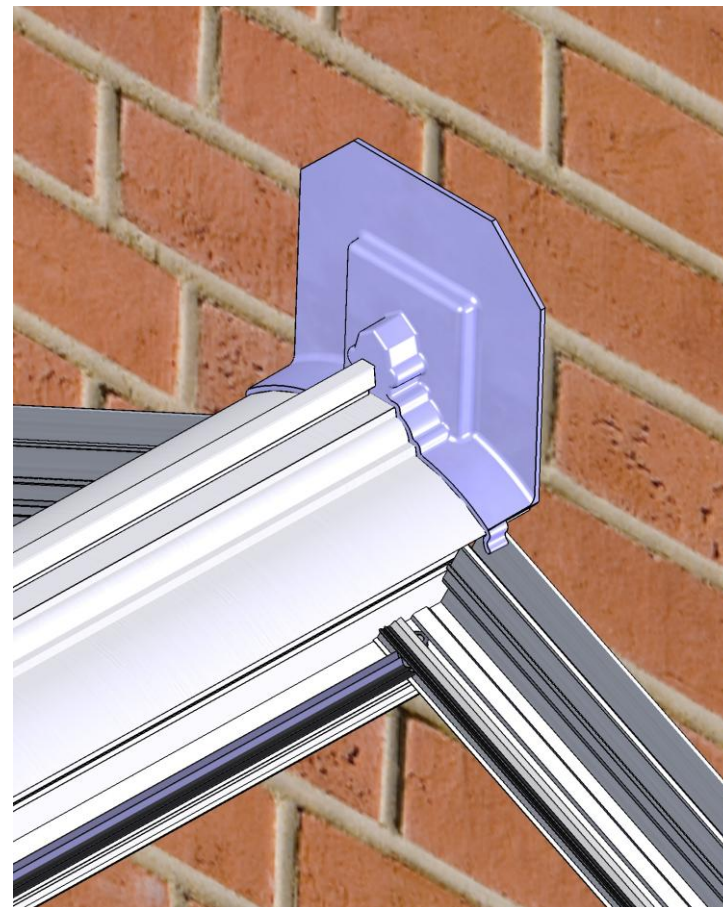

1. Apply Silicone Sealant to top of Ridge Cover.
2. Clip Flashing Trim over Ridge Cover.

B

Ridge Cover Inline Joints

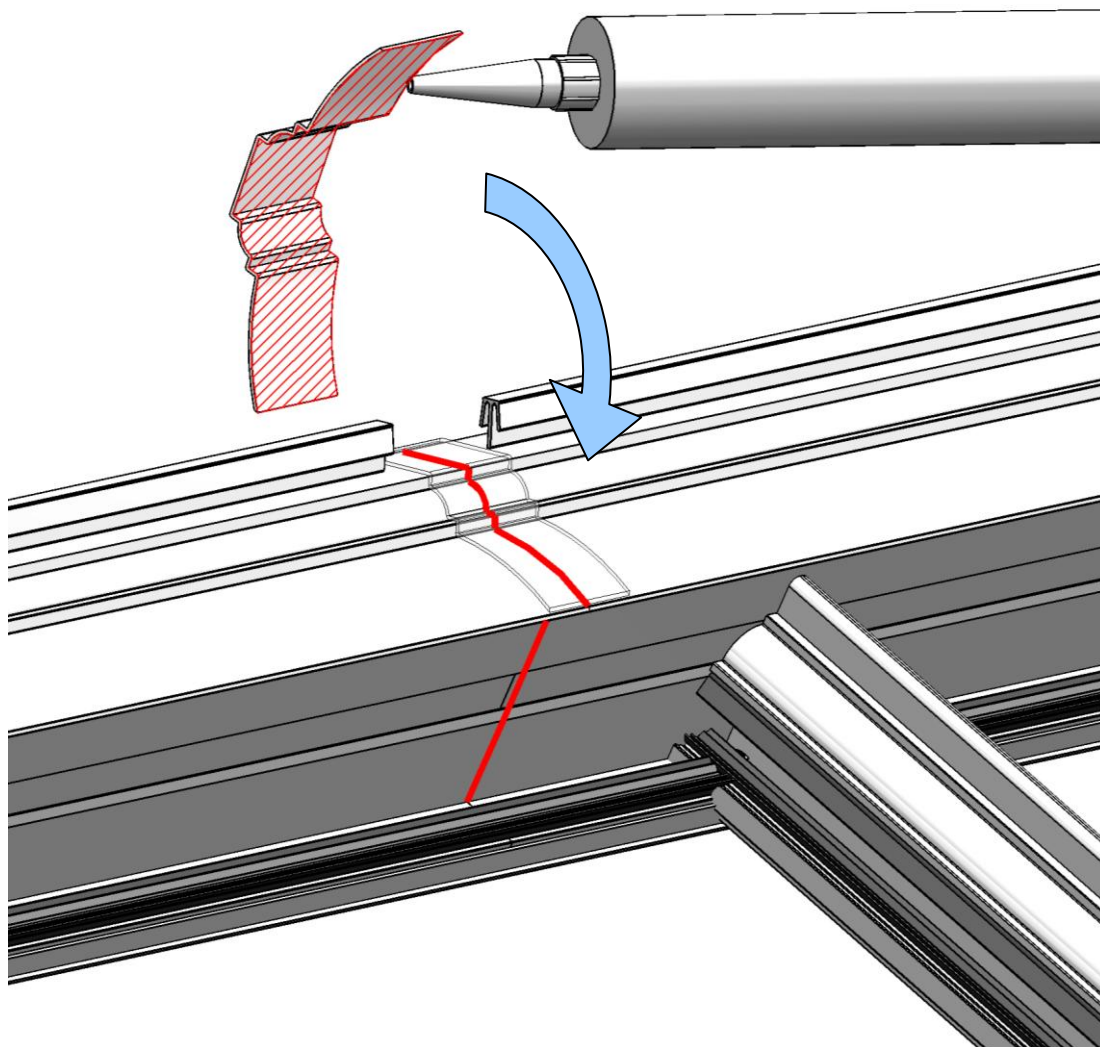

1. Apply a bead of Silicone where the Wings meet inside and out. Try to get between the joint as best you can.
2. Smooth over with finger on the outside face ensuring the Bead channels are clear.
3. Assemble Ridge Cover as detailed on Page 5.
4. Seal between joints where possible and smooth over.
5. Apply Silicone to base of Inline Joint Cover.
6. Firmly press into place ensuring as low profile as possible.
7. Remove/smooth over any excess Silicone.
8. Notch cresting over Inline Joint Cover.



Flashing at Ridge

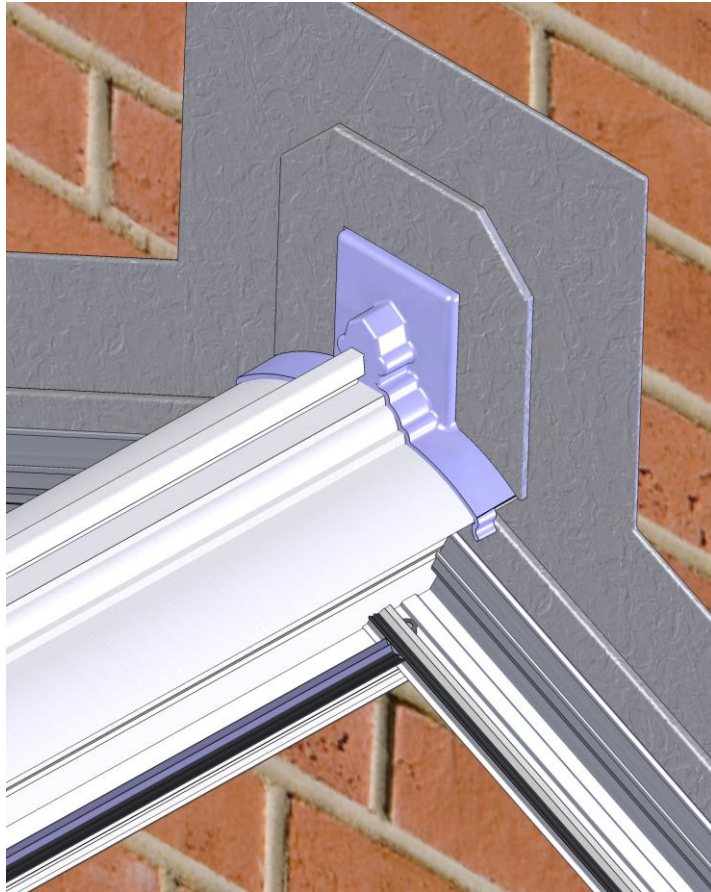

1. Dress lead flashing over Ridge Cover Flashing Trim.



Flashing at Wall Bar

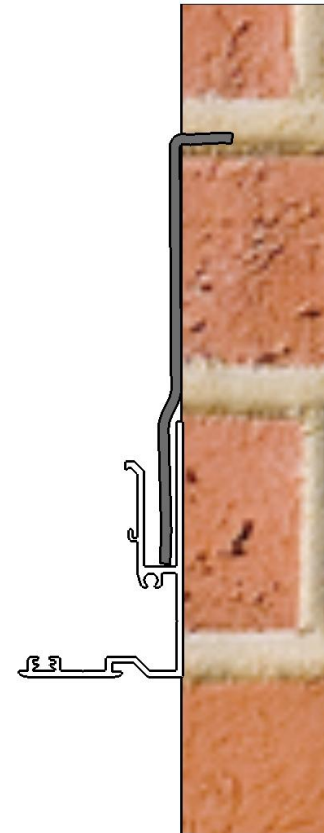

1. Dress lead flashing into Wall Bar flashing channel.

E

Glazing Panels

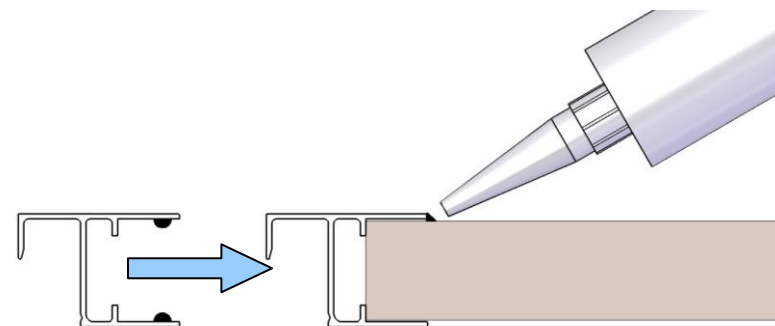
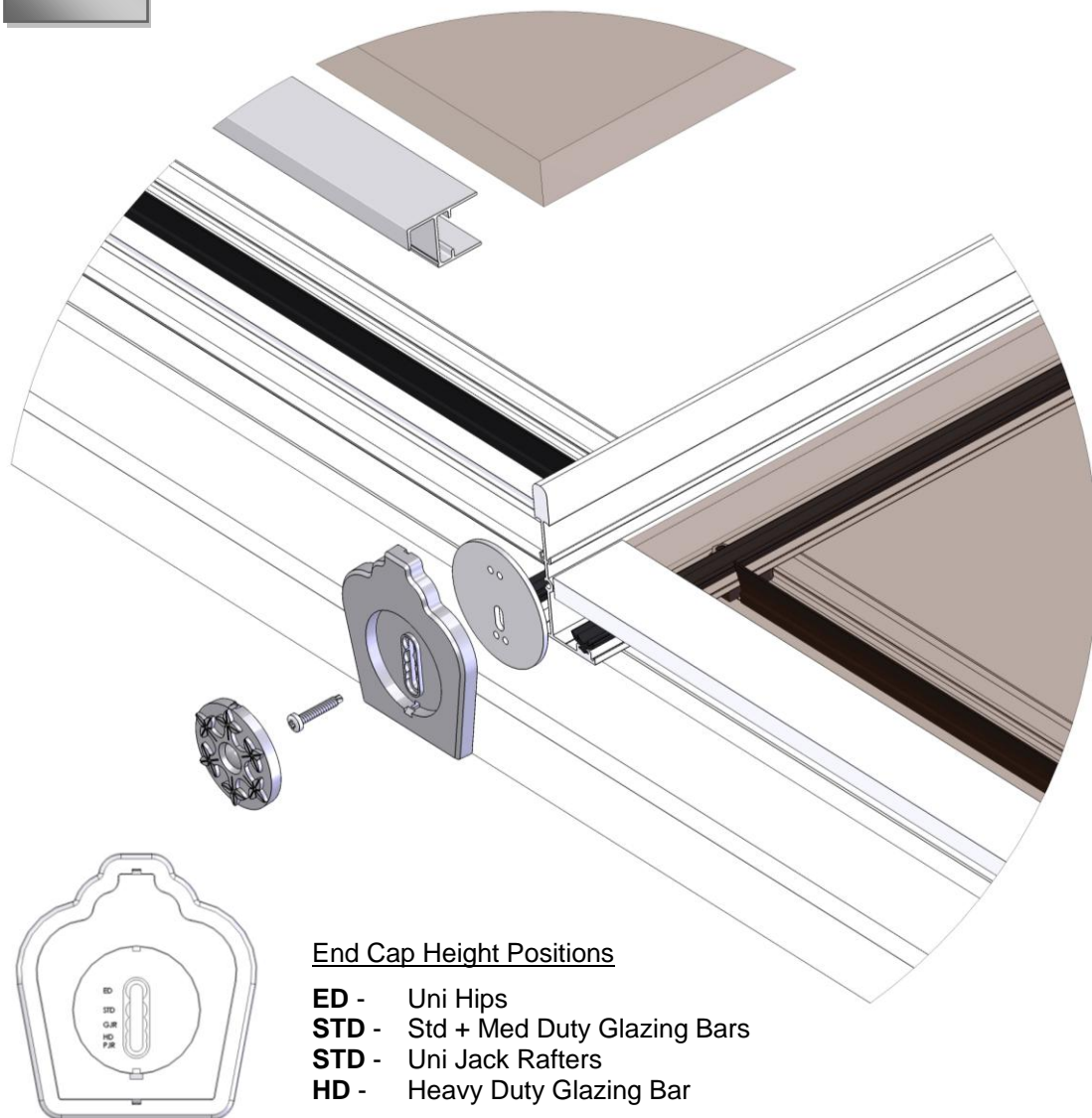

Glass Joiner

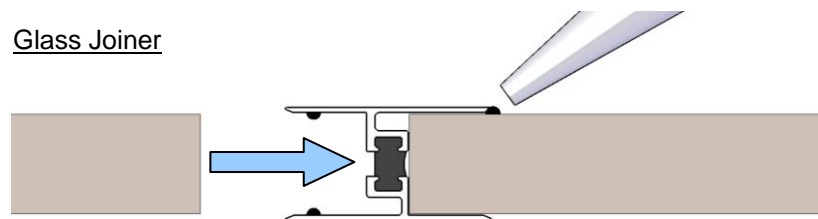

1. Screw End Caps onto ends of Glazing Bars. The Stepper + Glazing Panel rests against the End Cap assembly. Ensure the circular retaining Plates are used between the Stepper and the End Cap.
2. Apply Silicone to inside of Stepper (as above).
3. Push Stepper onto end of Glazing Panel.
4. Apply Silicone to leading edge of Stepper against glazing.
5. Carefully lift glazing in place.
6. Centralise Glazing Panel between Bars.

NOTE: For sealing Glass Joiner (Muntin Bar) use the same method as detailed in Steps 2 – 4.

NOTE: Start glazing from wall outwards, and glaze alternate sides of the ridge to ensure uniform loading and prevent movement.

Use roof vent aperture for access to Ridge for fitment of Cresting and Finial, otherwise we would recommend leaving out one glazing panel at this stage.



Glazing Beads

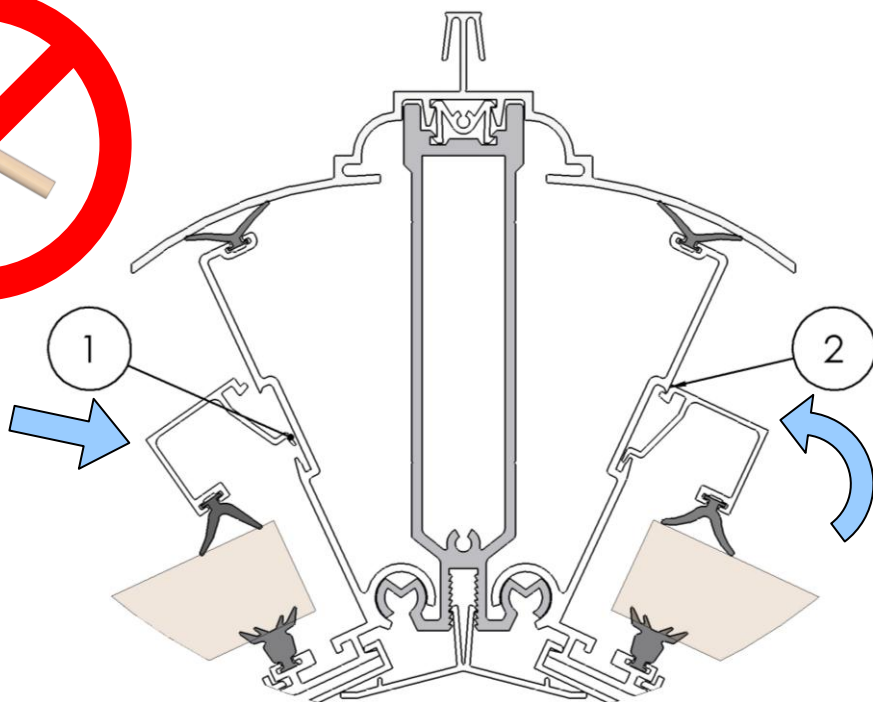

1. Fit Square bead between Glazing Bars first.
2. Engage lower leg of bead into groove ①.
3. Work from one end of Bead to the other using thumb pressure on the bead to compress the Gasket and engage top clip of Bead ②.
4. Apply constant pressure to Bead as you work along. It should clip into place.
5. Use Ogee Bead for Glazing Bars & Jack Rafters. Butt up to Square Beads on Ridge Wings and Hips.

NOTE: For longer Uni Hips with many Jack Rafters the square bead may be supplied split into two pieces at a Jack Rafter. This will allow glazing of the Hip in stages. Sealing the join in the bead is not required.

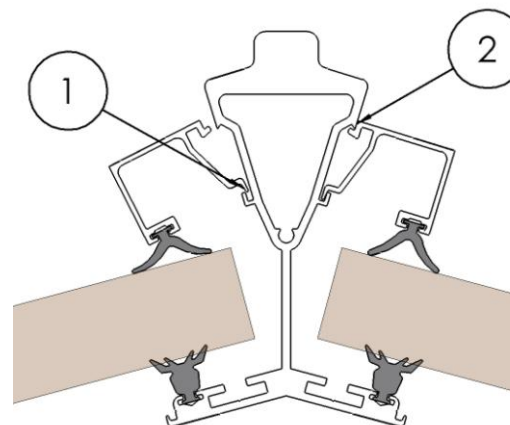

Uni Hip

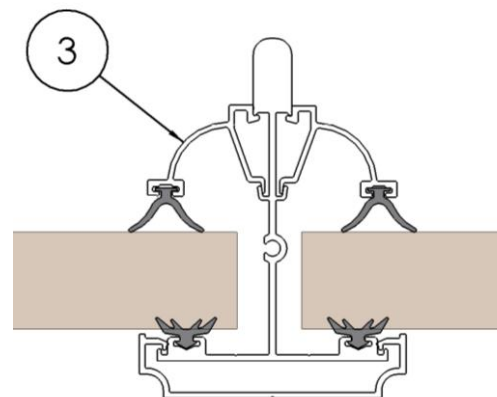

Glazing Bar

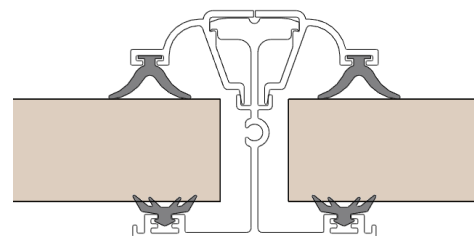

Jack Rafter

Bead Identification



6mm Bead = 41mm
24mm Bead = 23mm
32mm Bead = 15mm
35mm Bead = 12mm



6mm Bead = 41mm
24mm Bead = 23mm
32mm Bead = 15mm
35mm Bead = 12mm



6mm Bead = 39mm
24mm Bead = 21mm
32mm Bead = 13mm
35mm Bead = 10mm



Uni Ridge Gasket

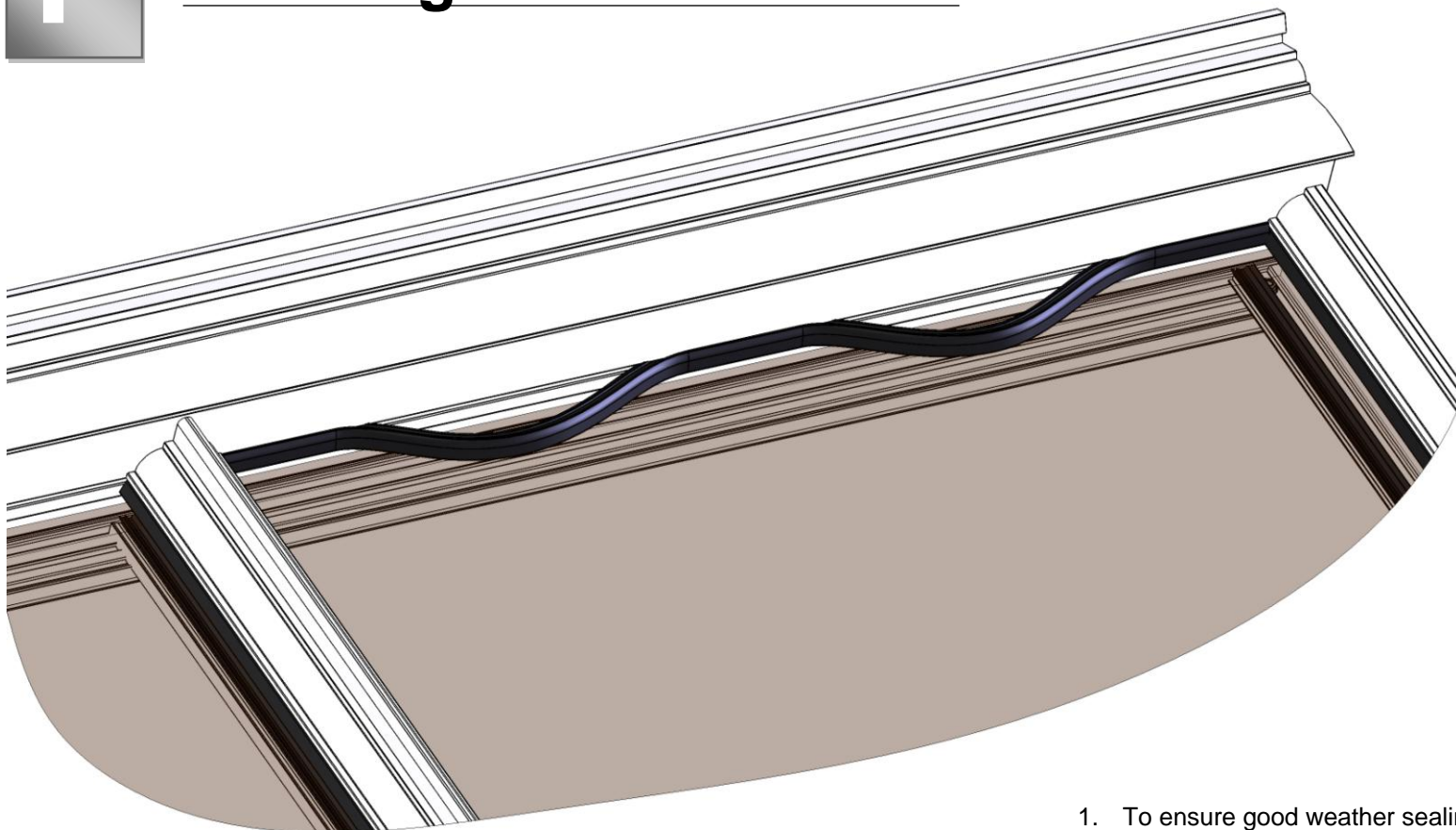

Gasket Profile

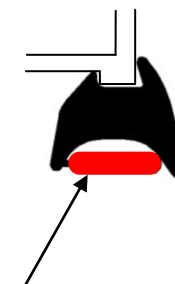

Tear off.

1. To ensure good weather sealing, cut Wedge Gasket 25mm oversize to avoid contraction.
2. Push in each end of the Gasket in place under the lip of ridge then insert the centre of the loop.
3. Continue until all the gasket is secured in place.

NOTE: At lower ridge pitches the Gasket may be hard to fit. In this instance, tear off the gasket strip (Shown above). Some soapy water can act as a lubricant if the gasket feels dry.



Top Cap and Finial

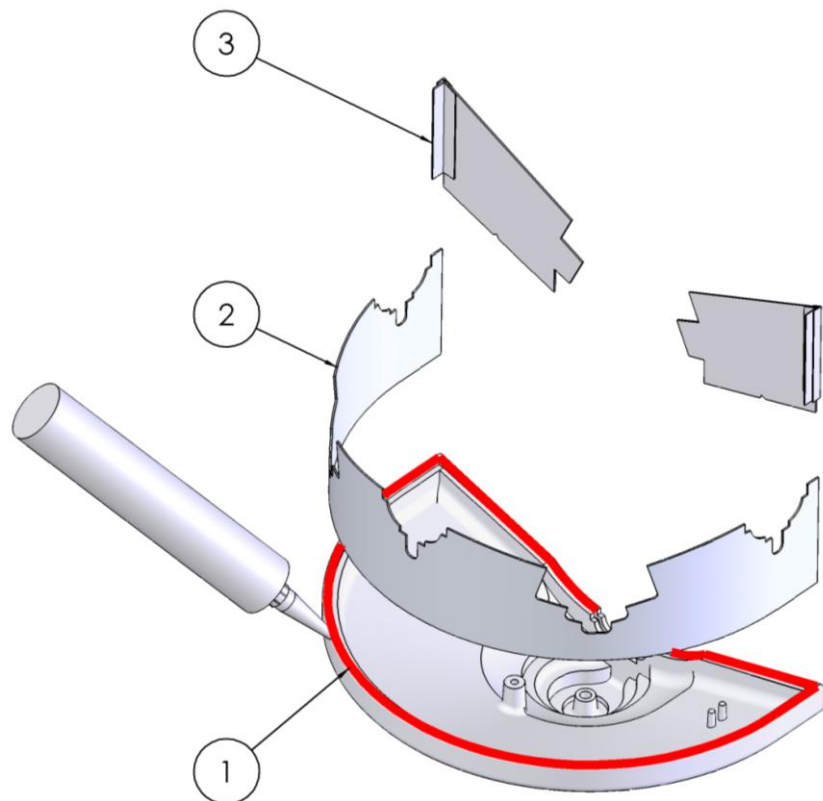

1. Invert Gallery Top Cap & apply sealant to perimeter groove (highlighted).
2. Bend Front Screen & insert into Top Cap groove.
3. Once Cap has been assembled to Ridge insert Rear Screen into Top Cap groove as shown opposite.

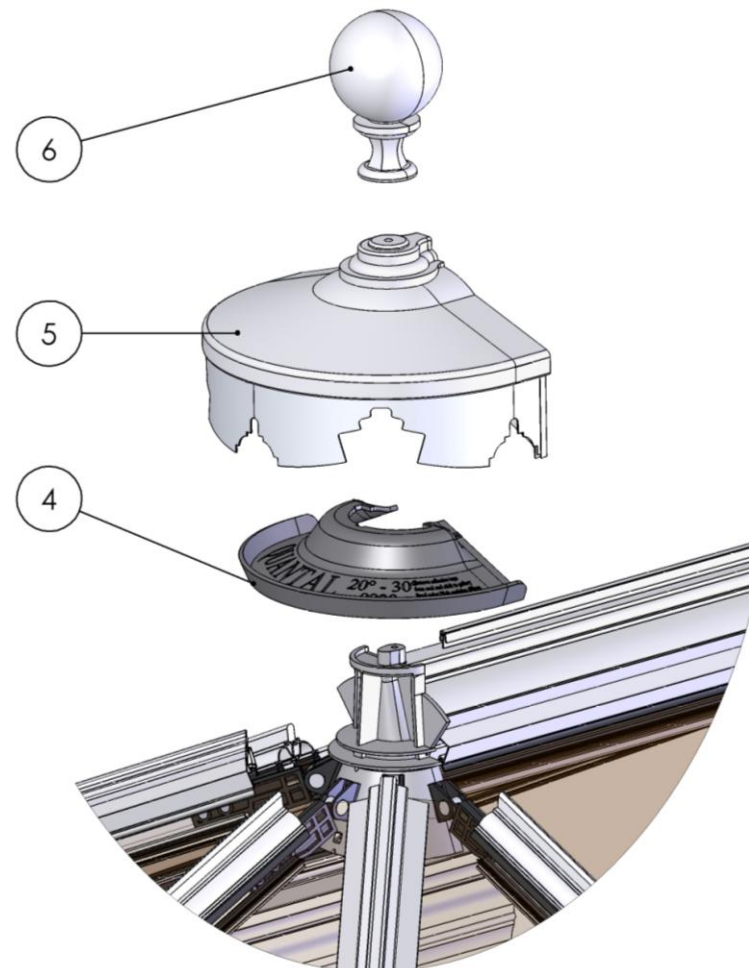

4. Fit Gallery Seal & apply silicone sealant to all touching surfaces (as shown on next page).
5. Fit Top Cap assembly.
6. Screw Finial through Top Cap & into top of Gallery.

F

Gallery Seal

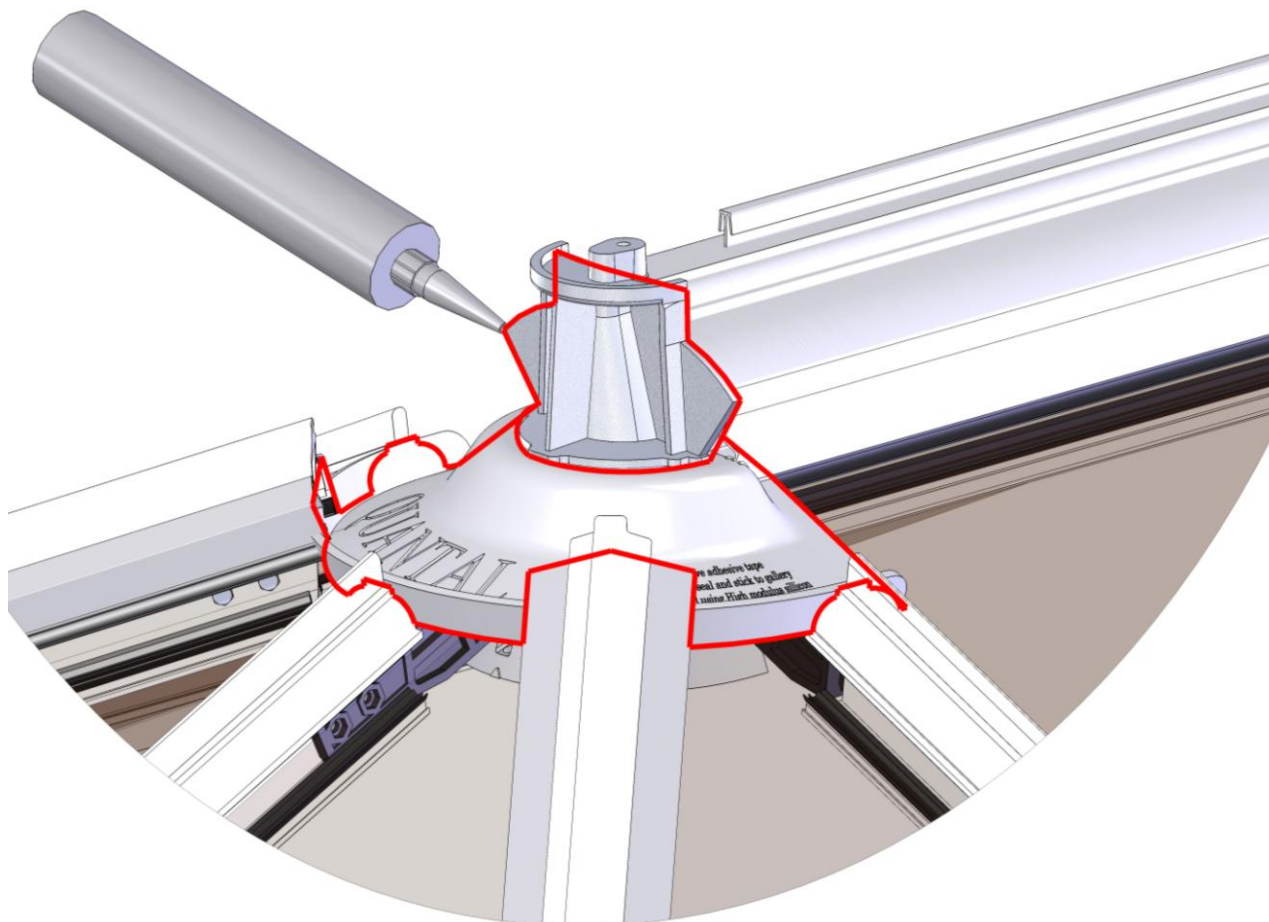

1. Apply a 10mm wide bead of silicone to the top surface of the glass for the Seal to sit on.
2. Press down Seal onto glass. Manipulate as required in order to provide a good compression with the glass and end of the Bars.
3. Apply silicone around perimeter of Seal and over the ends of the bar.
4. Silicone Seal to Gallery.
5. Silicone all joints between the Gallery and Ridge components.
6. Check for gaps.

F

Cresting

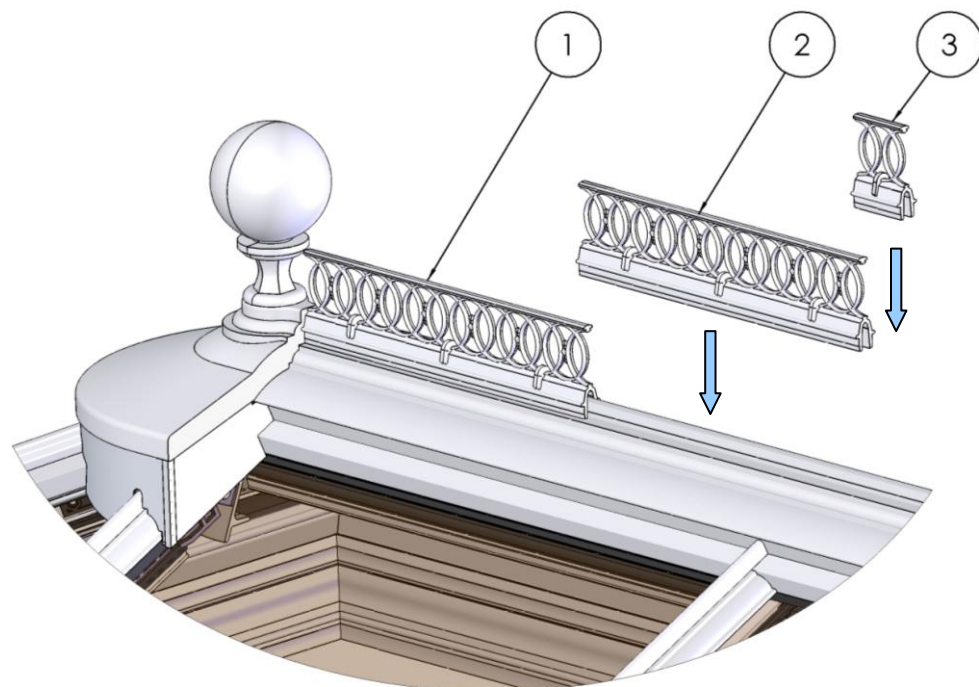

1. Start fitting Cresting from Gallery end.
2. Apply downward pressure until home.
3. Fit next piece tight up against first.
4. Insert infill piece at wall end.

F

Undercap

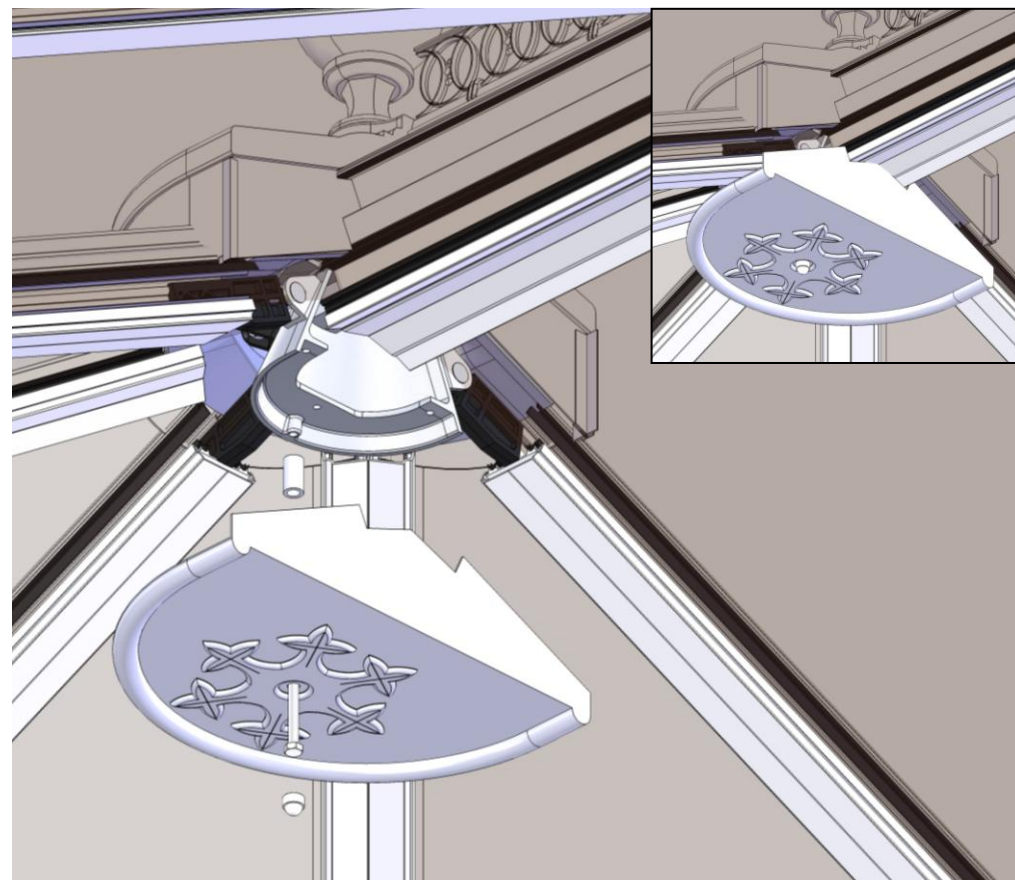

1. Trim Undercap rear upstand to required pitch as per the label.
2. Cut plastic Bolt and Spacer to the correct length.
3. Insert Bolt through Undercap and Spacer and screw into base of Gallery
4. Finish with Nut cover.



Guttering

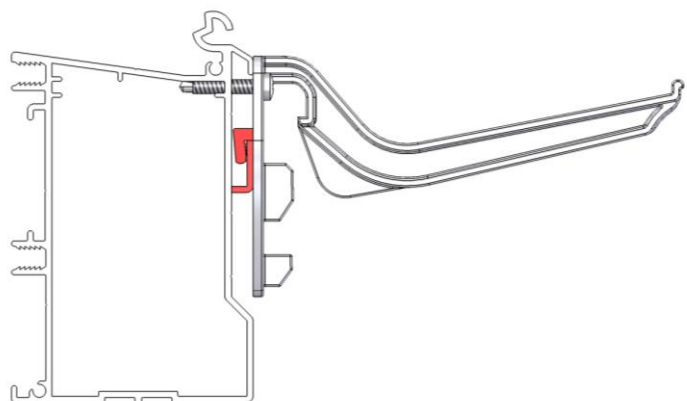
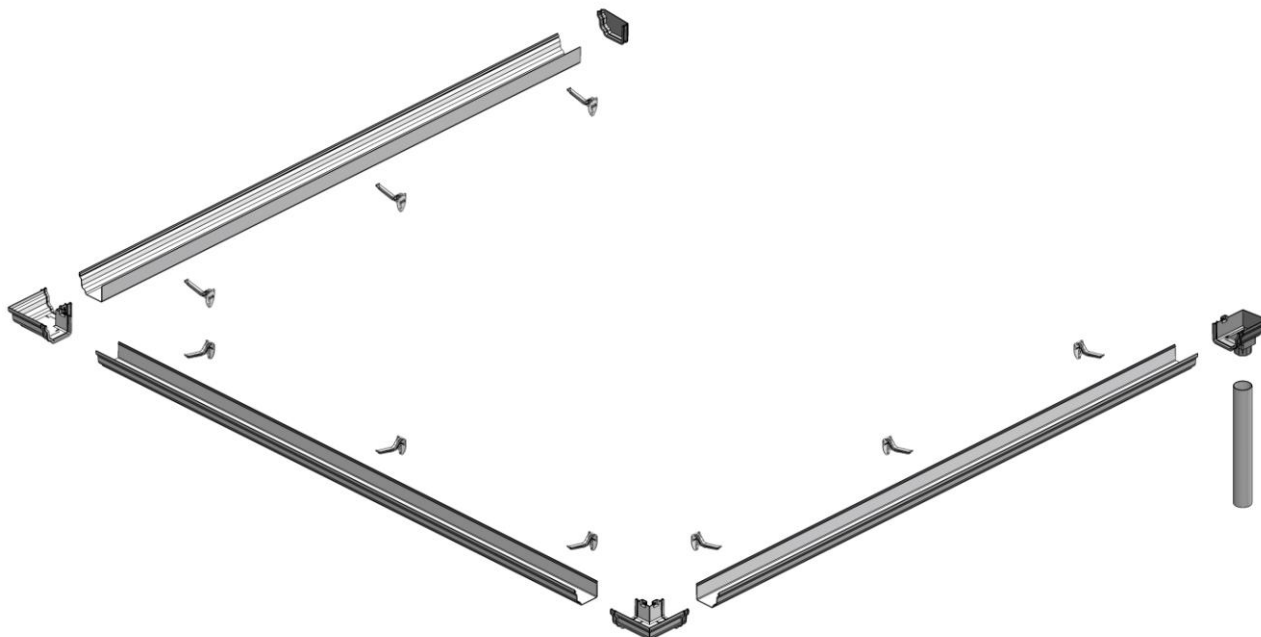
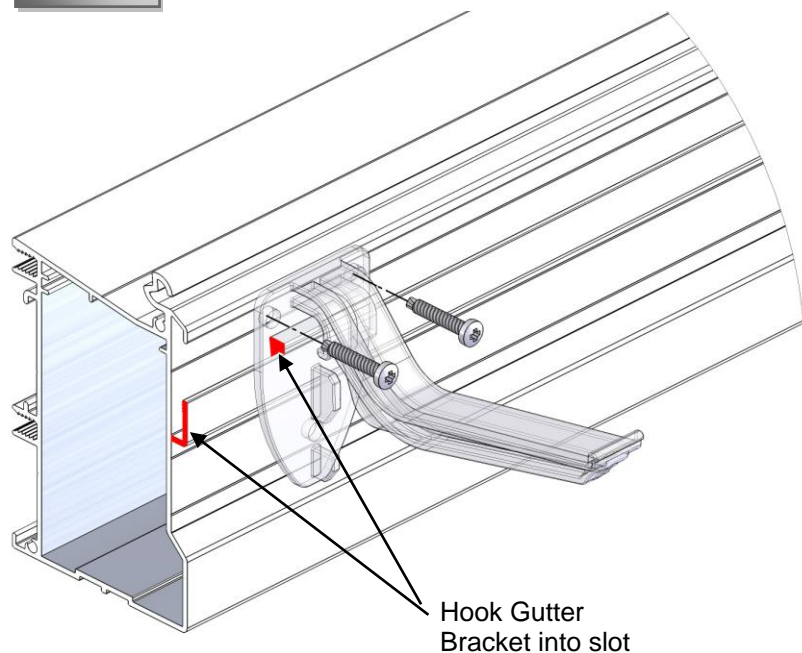

1. Fit Gutter Brackets into slot in face of Eaves Beam at 650mm centre spacings.
2. We would recommend securing Gutter Bracket to Eaves Beam with a pair of screws shown.
3. Start at stop end. Clip Guttering into Bracket working around the roof to Stop End Outlet.
4. Secure Downpipe Brackets to structure & assemble Downpipe to Stop End Outlet



Gable End Frame Notch

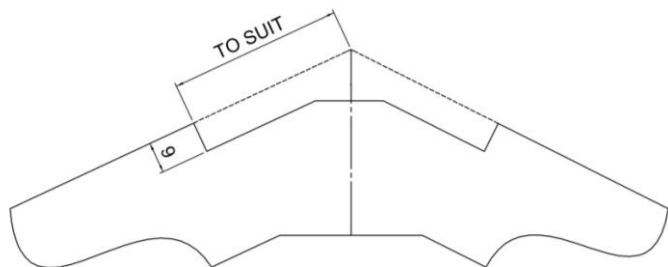
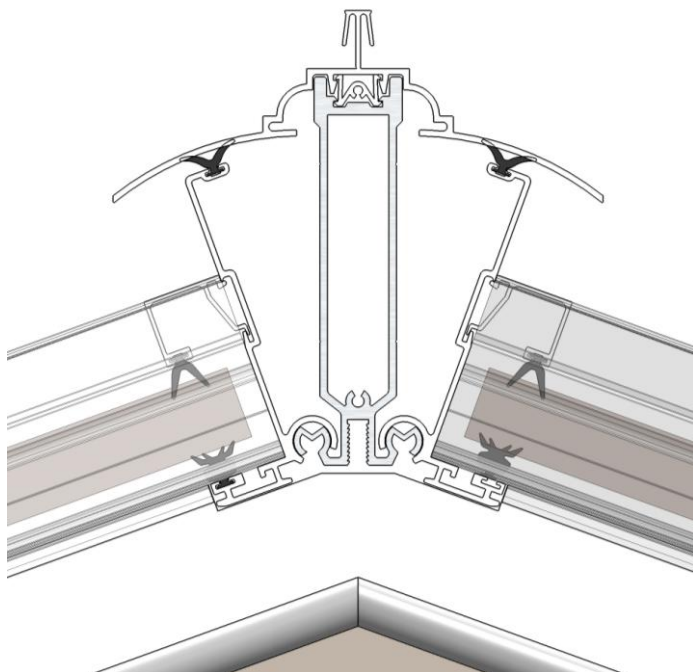

1. A Gable End Frame will require a notch in order to clear the Ridge Wings. Please ensure this detail present on the frame supplied.



Gable End Furring

Shown with Gable Cill. See End Cap picture for window alternative.

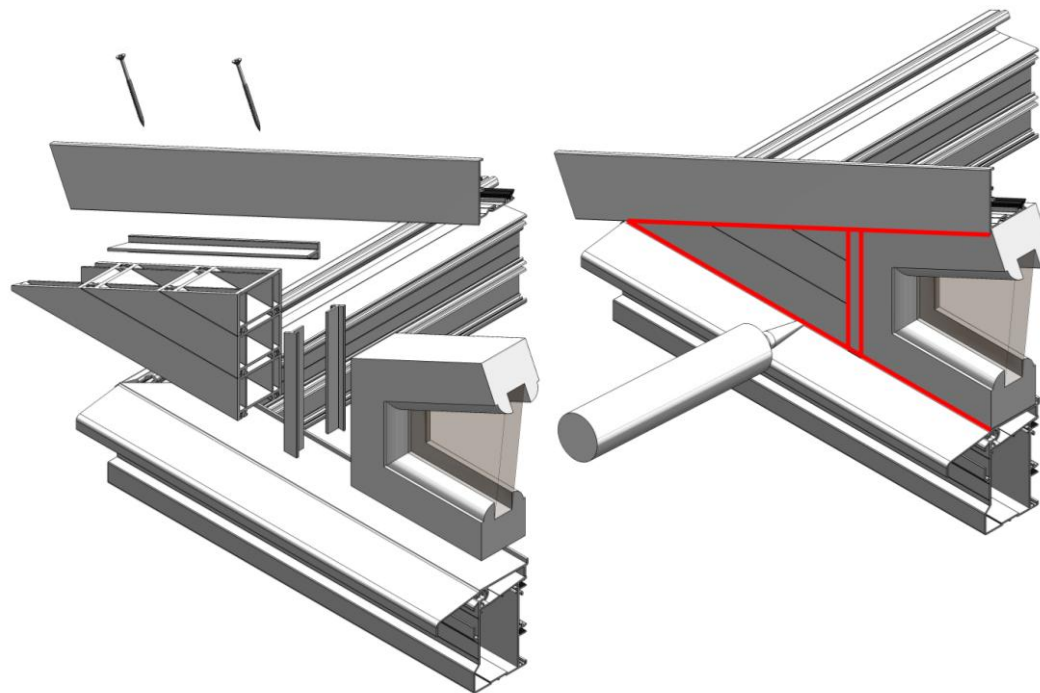

1. Assemble Gable Furring Pack as shown and silicone all joints.
2. Place Gable End Frame on the Cill and centralise along Eaves Beam. Silicone joints.
3. Silicone along the top edge of Furring and Window Frame.
4. Locate Glazing Bar over Furring / Window Frame assembly.
5. Fix at Eaves and Ridge.
6. Use screw fixings to screw End Bar to Furring and Window Frame at 150mm centres.
7. Glaze Roof.

F

Gable Finial

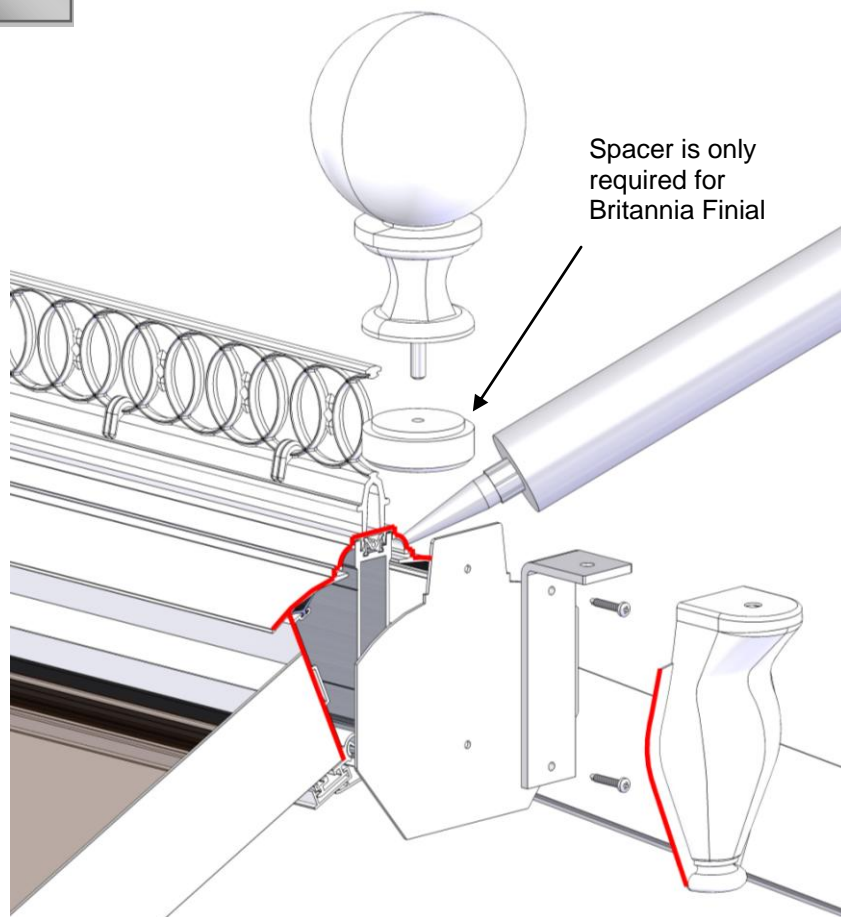

1. Silicone around edge of Ridge Cover and Wings.
2. Screw 'L' shaped bracket and End Plate to end of Ridge.
3. Silicone PVC outer cover to End Plate.
4. Screw Finial through Spacer into 'L' Bracket.

F

Eaves Beam End Cap

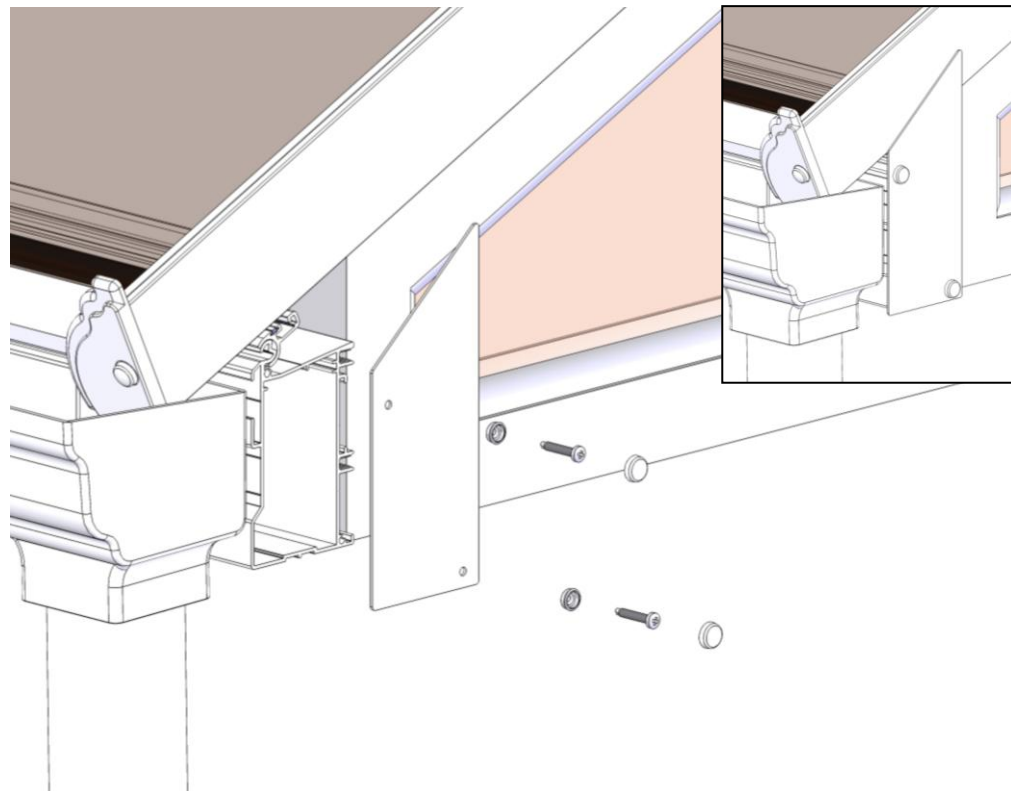

1. Apply Silicone to end face of Eaves Beam profile.
2. Position End Cap over Eaves Beam.
3. Assemble Screw Cup to Screw and fix End Cap to Eaves Beam
4. Push Screw Cap Covers over cup to finish.